

Heat transfer oil systems

Oil pump HTO 300 (old model)

- Repair kit

(500457)



- Pump wheel

(105161)



- Shaft

(CEO0090)



- Hydraulic motor

(500895)



- Coupling rubber element (No longer available) (500073)
Can be replaced by the rubber element and coupling used for HTO 400



- Coupling (No longer available) (500478)
Can be replaced by the rubber element and coupling used for HTO 400



Common spare parts “Equipment”

2013-01-02

Oil pump HTO 400 (new model)

- Repair kit (510790)
- Pump wheel (509030)
- Shaft (201098)
- Hydraulic motor (500895)
- Coupling rubber element (510251)
- Coupling (510250)

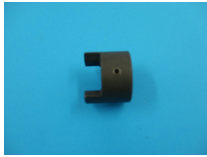
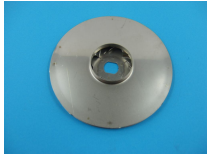

Common spare parts “Equipment”

2013-01-02

Other parts

- Valves

- 1” (between boiler and pump) (500384)



- ¾” Borum standard (500385)



- ¾” Ball valve with air screw for quick shift (510274)



- ¾” Ball valve without air screw for quick shift (503018)



- ½” Ball valve (503015)



- List of hoses 1” (for pump connection)

- 0 - 90 650mm (510426)



- List of hoses 3/8” (for Dot´n line and rib line box)

- 0 - 0 400mm (504706)



Common spare parts “Equipment”

2013-01-02



- List of hoses 0-90

- 250mm (503619)
- 350mm (503491)
- 450mm (503493)
- 550mm (503485)
- 650mm (503487)
- 750mm (503489)
- 850mm (503481)
- 950mm (503483)
- 1050mm (503475)
- 1150mm (503477)
- 1250mm (503479)
- 1350mm (503621)
- 1450mm (503470)
- 1550mm (504634)
- 1650mm (503623)
- 1750mm (503472)



- List of hoses 0-0

- 250mm (503618)
- 350mm (503490)
- 400mm (500423)
- 450mm (503492)
- 550mm (503494)
- 650mm (503486)
- 750mm (503488)
- 850mm (503480)
- 950mm (503482)
- 1050mm (503484)
- 1150mm (503476)
- 1250mm (503478)
- 1350mm (503620)
- 1450mm (503469)
- 1550mm (503636)
- 1750mm (503471)